

**12" GROOVING DETAIL**

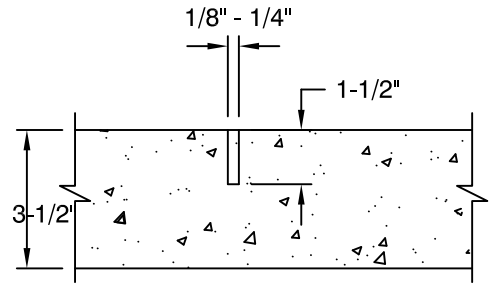

**WEAKENED PLANE JOINT (WPJ)**

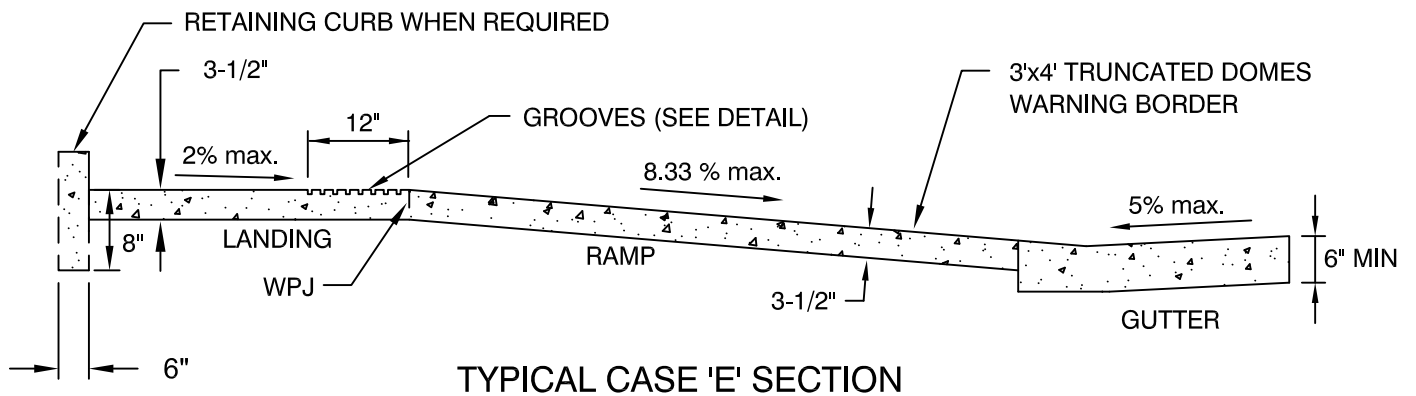

**TYPICAL CASE 'E' SECTION**

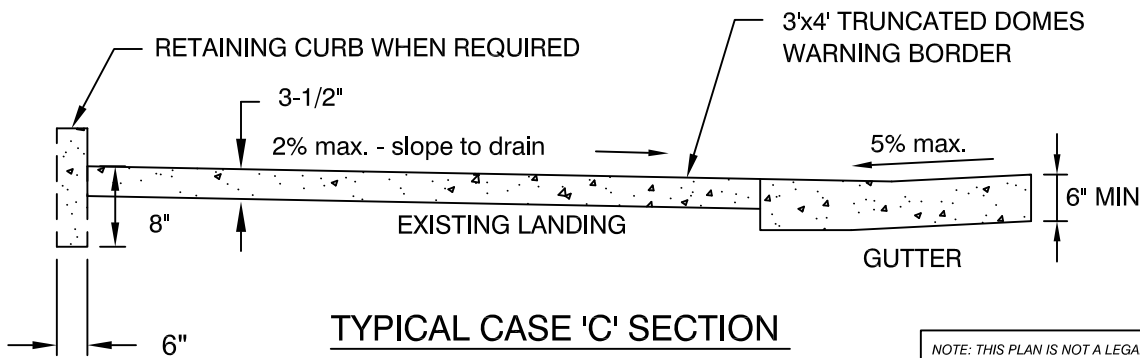

**TYPICAL CASE 'C' SECTION**

NOTE: THIS PLAN IS NOT A LEGAL ENGINEERING DOCUMENT BUT AN ELECTRONIC DUPLICATE. THE SIGNED CITY OF OAKLAND STANDARD DETAILS FOR PUBLIC WORKS CONSTRUCTION IS AVAILABLE FOR PURCHASE FROM THE CONTRACT ADMINISTRATION DEPARTMENT.

THIS SHEET IS FOR GUIDANCE ONLY. ALL CURB RAMPS SHALL BE CONSTRUCTED PER THE MOST RECENT EDITIONS OF THE AMERICAN WITH DISABILITIES ACT (ADA) AND THE CALIFORNIA TITLE 24 ACCESSIBILITY GUIDELINES

CITY OF OAKLAND

DESIGN AND CONSTRUCTION SERVICES DEPARTMENT



**CURB RAMP DETAILS**  
SHEET 4 OF 6  
TYPICAL SECTIONS

ENGINEERING DESIGN MANAGER

DATE: OCTOBER 2002  
REV. DATE: NOVEMBER 2004

DWG.

S-6