

CONCRETE ENCASED ELECTRODE WRAP #6 BARE COPPER GROUNDING ELECTRODE AROUND PERIMETER OF BOTTOM REBAR LAYER. SECURE WITH TIE WIRE AND EXTEND UP CENTER OF FOUNDATION, LEAVING 3' MIN. PIGTAIL.

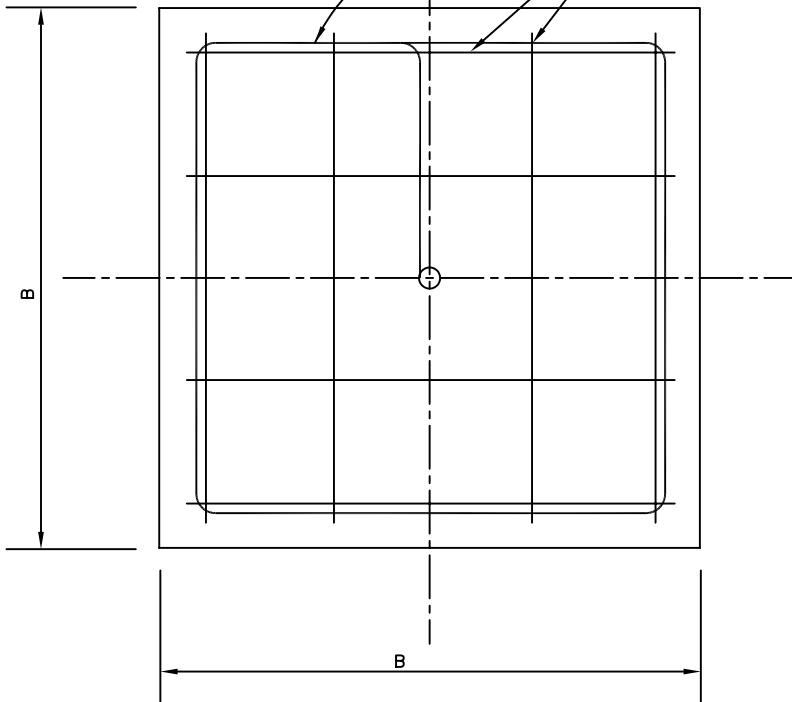

FDN. TYPE	FOOTING SIZE		REINFORCING	
	B	D	a	b
A	4'-6"	3'-0"	6-#5	3-#5
D	3'-0"	3'-0"	3-#5	3-#5

NOTE: THIS PLAN IS NOT A LEGAL ENGINEERING DOCUMENT BUT AN ELECTRONIC DUPLICATE. THE SIGNED CITY OF OAKLAND STANDARD DETAILS FOR PUBLIC WORKS CONSTRUCTION IS AVAILABLE FOR PURCHASE FROM THE CONTRACT ADMINISTRATION DEPARTMENT.

CITY OF OAKLAND

DESIGN AND CONSTRUCTION SERVICES DEPARTMENT



SPREAD FOUNDATION
FOR
LIGHT STANDARDS

ELECTRICAL SERVICES MANAGER

DATE: OCT 95
REV. DATE: DEC 2002

DRWG.

E-73