

SOURCE: nbj; Interstice Architects

Kaiser Permanente OMC Replacement Project Pre-Construction Notification . 205085

Figure 8
 Conceptual Landscape
 Master Plan

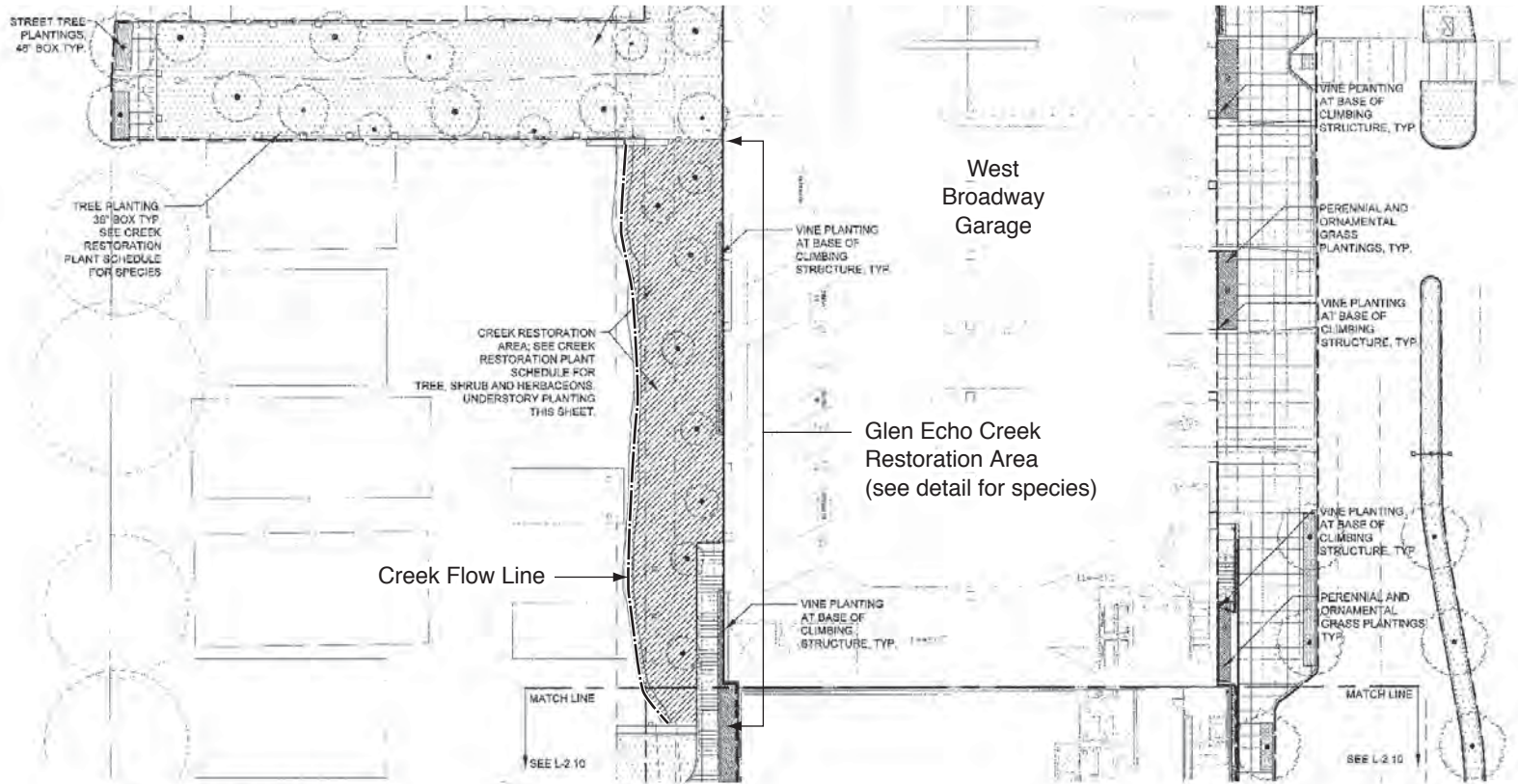

1 GARAGE LANDSCAPE MATERIAL PLAN

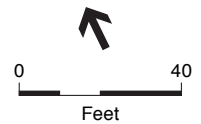

CREEK RESTORATION PLANT SCHEDULE:

SYMBOL	LATIN NAME	COMMON NAME	SIZE	SPACING	REMARKS
TREES					
	<i>Alnus rhombolia</i>	Alder	1.5 gal	20' o.c.	Qty: 3
	<i>Arcur macrophyllum</i>	Bogard Maple	5 gal	30' o.c.	Qty: 1
	<i>Alnus rhombolia</i>	Bear Star	5 gal	30' o.c.	Qty: 3
	<i>Pipulus fremontii</i>	Fremont Cottonwood	5 gal	20' o.c.	Qty: 2
	<i>Amelanchier californica</i>	Flackberry	5 gal	20' o.c.	Qty: 3
SHRUB UNDERSTORY					
	<i>Rhamnus californica</i>	California coffeeberry	1 gal	8' o.c.	Qty: 10
	<i>Rosa californica</i>	California rose	1 gal	8' o.c.	Qty: 25
	<i>Rubus ursinus</i>	California blackberry	1 gal	5' o.c.	Qty: 25
	<i>Salix lasiolepis</i>	Red Willow	1 gal	8' o.c.	Qty: 30
	<i>Symphoricarpos elaeagnifolia</i>	Snowberry	1 gal	8' o.c.	Qty: 12
	<i>Cornus sericea</i>	American dogwood	1 gal	8' o.c.	Qty: 4
	<i>Lonicera involucrata</i>	Black hollyhock	1 gal	8' o.c.	Qty: 10
	<i>Rhyacophloeus capitulatus</i>	Ninebark	1 gal	8' o.c.	Qty: 10
HERBACEOUS UNDERSTORY					
	<i>Ammannia douglasiana</i>	Mysort	1000ml	3' o.c.	Qty: 30
	<i>Hieracium cranyanthemum</i>	Meadow horsetail	1000ml	2' o.c.	Qty: 75
	<i>Laymus trichoides</i>	Crowfoot willow	1000ml	2' o.c.	Qty: 75
	<i>Arctostaphylos</i>	Yarrow	1000ml	3' o.c.	Qty: 15
	<i>Carum hirsutum</i>	Santa Barbara sedge	1000ml	2' o.c.	Qty: 15
	<i>Scoroparia californica</i>	Castanea figwort	1000ml	5' o.c.	Qty: 5

PLANTING NOTES:

- FOR TYPICAL SIZE SPACING AND SPECIES FOR 30TH STREET AND BROADWAY AVENUE FRONTAGE PLANTINGS SEE PRELIMINARY PLANT SCHEDULE THIS SHEET AS GENERAL REFERENCE.
- SPACING FOR CREEK RESTORATION IS BASED ON AN AVERAGE. ACTUAL SPACING SHALL BE ADJUSTED IN THE FIELD TO ACCOMMODATE OTHER SPECIES. SOME SPECIES ARE TO BE PLANTED IN CLUSTERS.
- PLANT SPECIES FOR MAIN ACCESS & WEST GARAGE LANDSCAPE ARE SIMILAR TO THOSE INDICATED IN CREEK RESTORATION PLANT SCHEDULE ABOVE. SPACING AND SIZES WILL VARY PER NOTES.
- PROVIDE STRAPPED LAYOUT OF ALL PLANT LOCATIONS FOR REVIEW BY LANDSCAPE ARCHITECT PRIOR TO PLANTING.

SOURCE: nbj



IF THIS SHEET IS NOT 30"X42", IT IS A REDUCED PRINT - SCALE ACCORDINGLY.



National Facilities Services
Post Office Box 12916
Oakland, California 94604

Revisions
No. Revision By Date Appr.

nbbj

130 Sutter Street, 2nd Floor
San Francisco, CA 94104
(415) 981-1100
(415) 733-2700 fax

INTERSTICE

ARCHITECTURAL, URBAN DESIGN, LANDSCAPE ARCHITECTURE
1411 14TH STREET, SAN FRANCISCO, CALIFORNIA 94101
PH: 415.774.2100 FAX: 415.774.2101

This document is the property of this Owner and is not to be used without owner's written permission.
Project Architect Approval:

Architect/Engineer Of Record:

DESIGN DEVELOPMENT
DECEMBER 5, 2005

Facility
OAKLAND MEDICAL CENTER
280 WEST MACARTHUR BLVD.
OAKLAND, CALIFORNIA 94611
Project
M.O.B. AT 3701 BROADWAY

Sheet Title
GARAGE LANDSCAPE PLANTING PLAN

File No. Dep. No. Plan. Lett. Submitt.

KP Proj. No.
MOB Proj. No. 111-976-00
CONTRACT FILE NO. 111-976-01
NBBJ Proj. No. 50280.00

Scale AS NOTED
Drawn By AS
Checked By ZA
Issue Date DEC. 5, 2005
Sheet L-2.02
Of Sheets

PRELIMINARY PLANT SCHEDULE:

SYMBOL	LATIN NAME	COMMON NAME	SIZE	SPACING	REMARKS
TREES					
MEL QUIN	<i>Melaleuca quinquenervia</i>	Paperbark	48" box	as shown	multi-stem, matched
OLE EUR	<i>Olea europaea</i> 'Swan Hill'	Frutless Olive	48" box	as shown	multi-stem, matched
PLA ACE	<i>Platanus x acerifolia</i>	London Plane	48" box	as shown	matched, potential street tree
ULM PAR	<i>Ulmus parvifolia</i>	Chinese Elm	48" box	as shown	matched, potential street tree
BAMBOO					
RAM 1	<i>Phyllostachys</i> sp. - TBD	Tree Bamboo	12 gal.	as shown	SEE PRELIMINARY PLANT SCHEDULE THIS SHEET
RAM 2	<i>Phyllostachys</i> sp. - TBD	Tree Bamboo	15 gal.	as shown	SEE PRELIMINARY PLANT SCHEDULE THIS SHEET
SHRUBS/PERENNIALS					
ESC CAL	<i>Eucalyptus californica</i>	California Poppy	4" pot	varies	
DIE VEG	<i>Dianthus vegeta</i>	Fortnight Lily	1 gal.	varies	
LAV ANG	<i>Lavandula angustifolia</i>	English Lavender	5 gal.	18" o.c.	'Munstead'
LAV INT	<i>Lavandula x intermedia</i>	Hedge Lavender	5 gal.	18" o.c.	'Provence' and 'Grosso'
SAL OFF	<i>Salvia officinalis</i>	Garden Sage	5 gal.	18" o.c.	
ORNAMENTAL GRASSES					
FES CAL	<i>Festuca californica</i>	California Fescue	1 gal.	15" o.c.	'Serpentine Blue'
HEL SEM	<i>Helictotrichon sempervirens</i>	Blue Oat Grass	1 gal.	15" o.c.	
MUH RIG	<i>Muhlenbergia rigens</i>	Dune Grass	5 gal.	2' o.c.	
VINES					
BEA GRA	<i>Besamondia grandiflora</i>	Estrel Lily Vine	5 gal.	2' o.c.	Broadway facade/parking area
DIS LAX	<i>Dalmanella laeviflora</i>	Vanilla Trumpet Vine	5 gal.	18" o.c.	west side of garage
JAS POL	<i>Jasminum polyanthum</i>	Pink Jasmine	5 gal.	18" o.c.	Broadway facade/parking area
PAR QUIN	<i>Parthenocissus quinquefolia</i>	Virginia Creeper	5 gal.	18" o.c.	Engelmann, west side garage
SOL JAS	<i>Solanum jasminoides</i>	Purple Vine	5 gal.	18" o.c.	Broadway facade/parking area
TEO CAP	<i>Tecoma capensis</i>	Cape Honeysuckle	5 gal.	18" o.c.	'Aurea'
VIT CAL	<i>Vitis californica</i>	Wild Grape	1 gal.	18" o.c.	west side of garage
GROUNDCOVER					
SEDUM SP	<i>Sedum</i> sp.	Sedum	4" pot	8"-12" o.c.	
ECHERANIS SP	<i>Echeveria</i> sp.	Vanilla Trumpet Vine	4" pot	8"-12" o.c.	
MUS	<i>Muscari</i>	Grapehyacinth	4" pot	8"-12" o.c.	
MYO PAR	<i>Myoporum Parvifolium</i>	Myoporum	4" pot	2' o.c.	Prostratum

CREEK RESTORATION PLANT SCHEDULE:

SYMBOL	LATIN NAME	COMMON NAME	SIZE	SPACING	REMARKS
TREES					
	<i>Alnus rhombifolia</i>	Alder	5 gal.	20' o.c.	qty: 3
	<i>Acer macrophyllum</i>	Bishop Maple	5 gal.	20' o.c.	qty: 1
	<i>Alnus rhombifolia</i>	Box Elder	5 gal.	20' o.c.	qty: 3
	<i>Populus fremontii</i>	Fremont Cottonwood	5 gal.	20' o.c.	qty: 2
	<i>Aesulus californicus</i>	Buckeye	5 gal.	20' o.c.	qty: 3
SHRUB UNDERSTORY					
	<i>Rhamnus californica</i>	California coffeeberry	1 gal.	5' o.c.	qty: 10
	<i>Rosa californica</i>	California rose	1 gal.	5' o.c.	qty: 25
	<i>Rubus urticaria</i>	California blackberry	1 gal.	5' o.c.	qty: 25
	<i>Salix lasiolepis</i>	Red Willow	1 gal.	5' o.c.	qty: 30
	<i>Symphoricarpos sibiricus</i> var. <i>lewisii</i>	Snowberry	1 gal.	5' o.c.	qty: 12
	<i>Cornus sericea</i> ssp. <i>sericea</i>	American dogwood	1 gal.	5' o.c.	qty: 4
	<i>Lonicera involucrata</i> var. <i>subcoccinea</i>	Black hawberry	1 gal.	5' o.c.	qty: 10
	<i>Physocarpus opulifolius</i>	Ninebark	1 gal.	5' o.c.	qty: 10
HERBACEOUS UNDERSTORY					
	<i>Arenaria douglasiana</i>	Mugwort	supercell	3' o.c.	qty: 30
	<i>Hordeum branichathrum</i>	Meadow barley	supercell	2' o.c.	qty: 75
	<i>Leymus trichoides</i>	Creeping wildrye	supercell	2' o.c.	qty: 75
	<i>Achilles millefolium</i>	Yarrow	supercell	3' o.c.	qty: 15
	<i>Carex bartera</i>	Santa Barbara sedge	supercell	2' o.c.	qty: 15
	<i>Scrophularia californica</i> ssp. <i>californica</i>	California figwort	supercell	5' o.c.	qty: 5

PLANTING NOTES:

- FOR TYPICAL SIZE SPACING AND SPECIES FOR 38TH STREET AND BROADWAY AVENUE FRONTAGE PLANTINGS SEE PRELIMINARY PLANT SCHEDULE THIS SHEET AS GENERAL REFERENCE.
- SPACING FOR CREEK RESTORATION IS BASED ON AN AVERAGE. ACTUAL SPACING SHALL BE ADJUSTED IN THE FIELD TO ACCOMMODATE OTHER SPECIES. SOME SPECIES ARE TO BE PLANTED IN CLUSTERS.
- PLANT SPECIES FOR MANILA ACCESS & WEST GARAGE LANDSCAPE ARE SIMILAR TO THOSE INDICATED IN CREEK RESTORATION PLANT SCHEDULE ABOVE. SPACING AND SIZES WILL VARY PER NOTES.
- PROVIDE STAKED LAYOUT OF ALL PLANT LOCATIONS FOR REVIEW BY LANDSCAPE ARCHITECT PRIOR TO PLANTING.

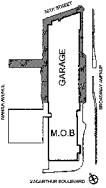

KEY PLAN

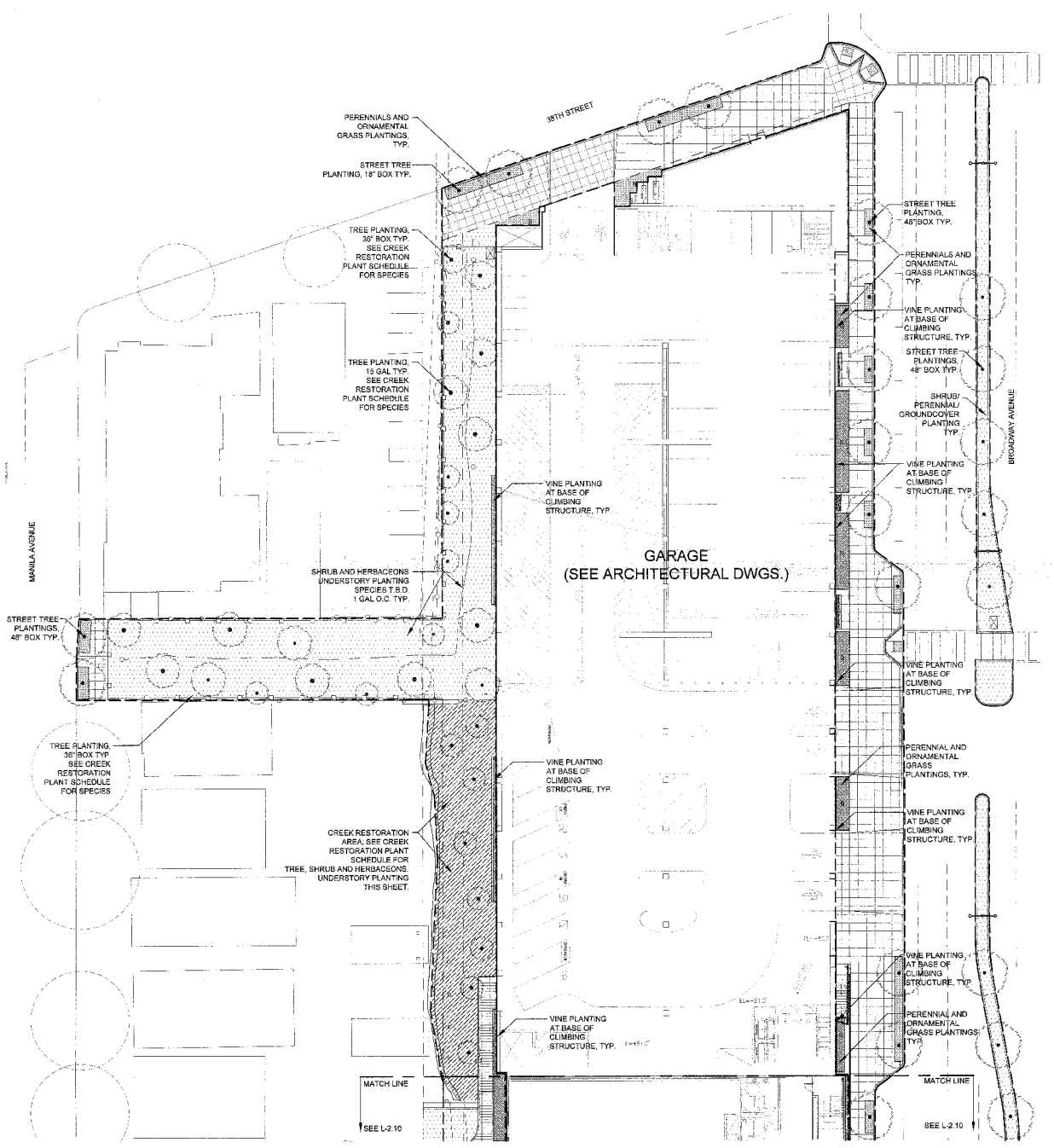

1 GARAGE LANDSCAPE MATERIAL PLAN
Scale: 1/16" = 1'-0"

